

# SQUBE ON TRACK

20-04-2018

## 1.0 LED

LED 6W | 220-240VAC | 50-60Hz | COB3-step | incl. PS | phase-cut dim

CE  $\oplus$   $\wedge$  38° IP20  $\square$  960°C  $\perp$  0,3m  $\oplus$   $\updownarrow$  90°  $\curvearrowright$  355°

white texture	144164W.
black texture	144164B.

### LIGHT COLOUR

2700K   >80CRI   350lm	2
3000K   >80CRI   380lm	4
1800-3000K   >80CRI   350lm	9

1-phase track accessories on second page

## 1.0 PAR16

PAR16 max. 35W | GU10 | 100-240VAC | 50-60Hz

CE  $\oplus$  IP20  $\square$  960°C  $\perp$  0,9m  $\oplus$   $\updownarrow$  90°  $\curvearrowright$  355°

white texture	144120W0
black texture	144120B0

### OPTIONAL

for PAR16 lamps see our catalogue  
1-phase track accessories on second page

④

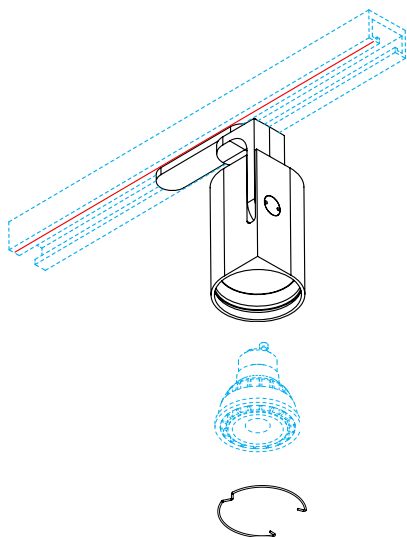

①

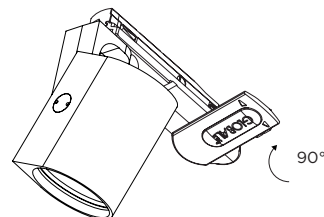

②



**SAFETY ISSUE!**  
**INSTALL THE FIXTURE**  
**CORRECTLY ON THE TRACK**  
(see remark 2)

③

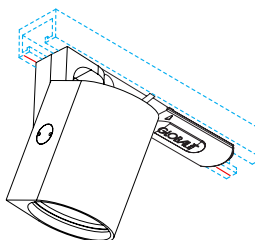

## DIMENSIONS

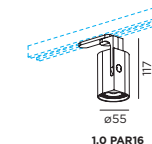
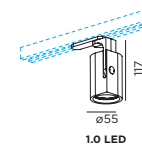

## MOUNTING INSTRUCTION

- ① Turn the handle, which is mounted on the fixture, 90°.
- ② Push the fixture into the track. Make sure the  $\oplus$  icon on the inside of the adaptor is faced towards the track side with the small line craved in it. (marked red in the drawing)

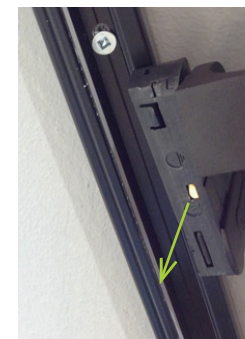

Make sure the handle is turned 90° when inserting the adapter into the track.

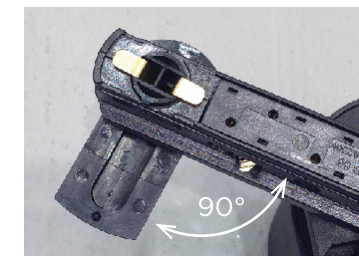

- ③ Turn the handle back into the original position.
- ④ For PAR16: mount the lamp into the fixture



**WEVER & DUCRÉ**  
LIGHTING

[www.weverducre.com](http://www.weverducre.com)

**INSTALLATION**  
**INSTRUCTIONS**

PAGE 1/2

# SQUBE ON TRACK

ACCESSORIES

## TRACK PROFILE 1m | 1-phase

white 90014001  
black 90014007



## TRACK PROFILE 2m | 1-phase

white 90014002  
black 90014008



## TRACK PROFILE 3m | 1-phase

white 90014003  
black 90014009

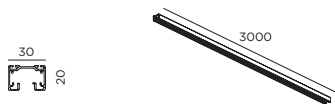

## END FEED left

white 90014018  
black 90014019



## END FEED right

white 90014020  
black 90014021

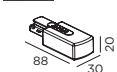

## MIDDLE FEED

white 90014036  
black 90014037

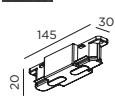

## CONNECTOR straight

white 90014022  
black 90014023



## L-CONNECTOR left

white 90014024  
black 90014025



## L-CONNECTOR right

white 90014026  
black 90014027



## END CAP

white 90014028  
black 90014029

